

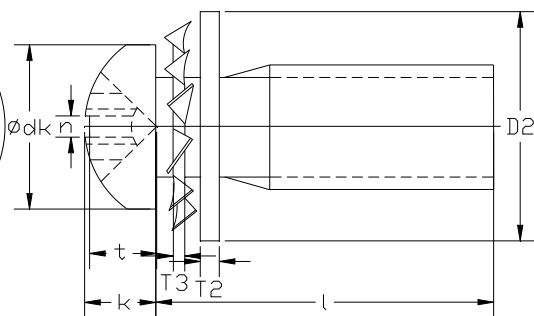

重 慶 三 等 重 慶 有 限 公 司
華 街 6 9 號

TEL : 02-28577979 FAX : 02-28579292

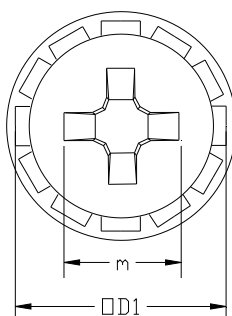

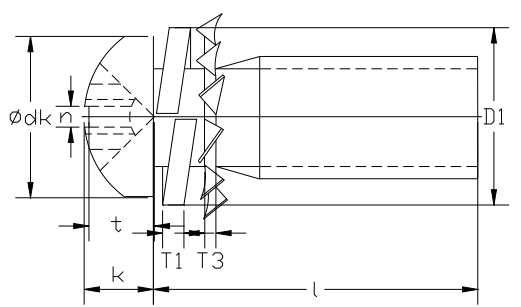
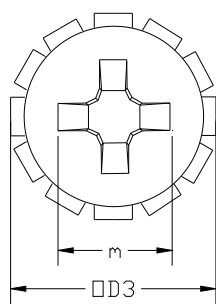
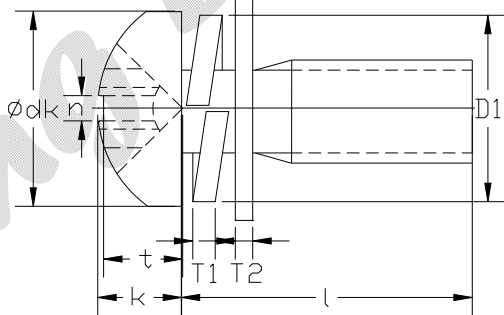
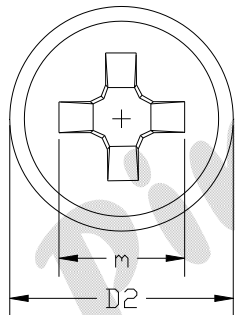
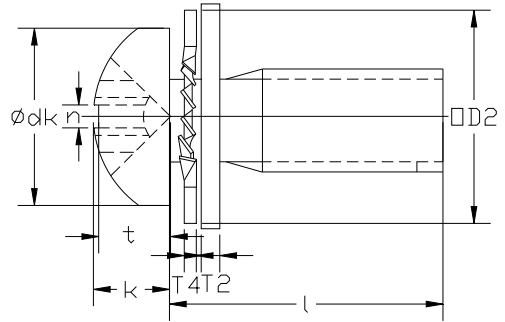
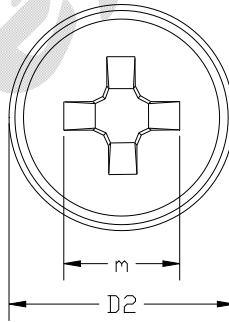
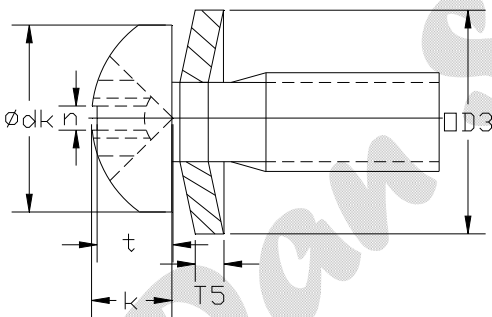
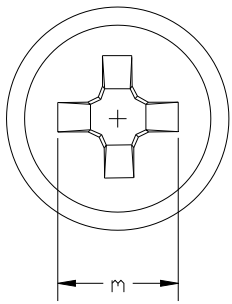
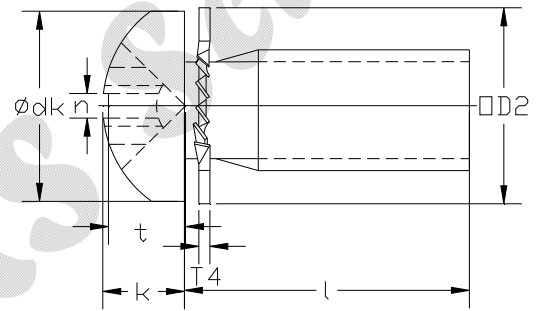
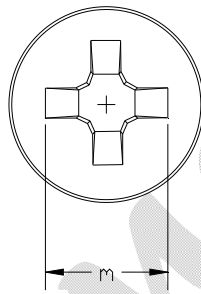
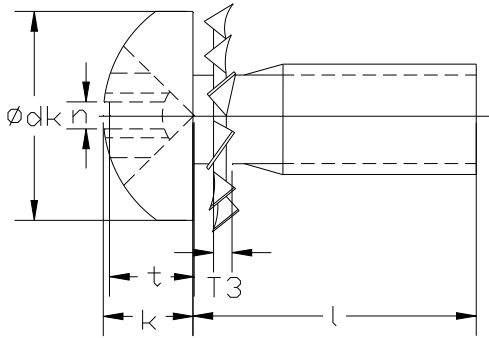
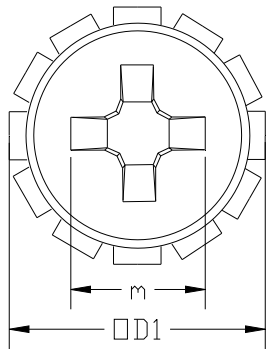
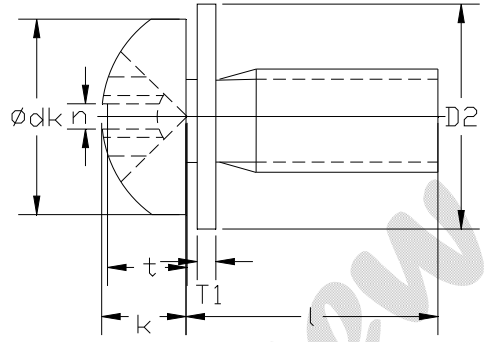
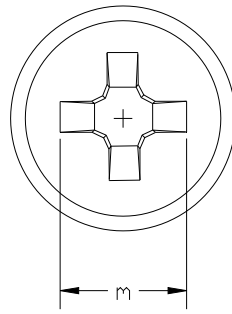
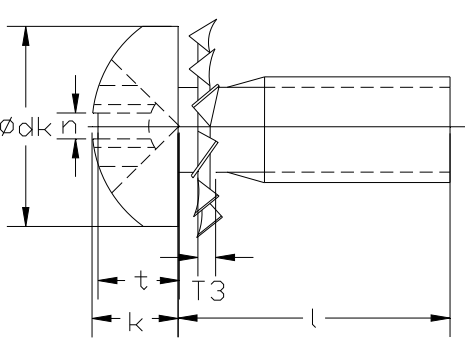
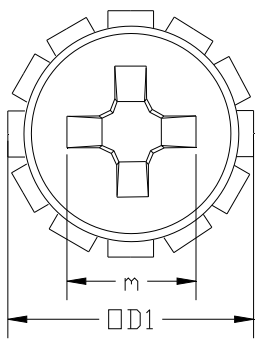

單位 INCH

Nominal Size or Basic Screw Diameter		2	3	4	5	6	8	10	12	1/4	5/16	
		0.0860	0.0990	0.1120	0.1250	0.1380	0.1640	0.1900	0.2160	0.2500	0.3125	
dk	Head Diameter	Max	0.167	0.193	0.219	0.245	0.270	0.322	0.373	0.425	0.492	0.615
		Min	0.155	0.180	0.205	0.231	0.256	0.306	0.357	0.407	0.473	0.594
k	Head Height	Max	0.062	0.071	0.080	0.089	0.097	0.115	0.133	0.151	0.175	0.218
		Min	0.053	0.062	0.070	0.079	0.087	0.105	0.122	0.139	0.162	0.203
m	Recess Diameter	Max	0.104	0.112	0.122	0.158	0.166	0.182	0.199	0.259	0.281	0.350
		Min	0.091	0.099	0.109	0.145	0.153	0.169	0.186	0.246	0.268	0.337
t	Recess Depth	Max	0.590	0.068	0.078	0.083	0.091	0.108	0.124	0.141	0.161	0.193
		Min	0.041	0.050	0.060	0.057	0.066	0.082	0.100	0.115	0.135	0.169
n	Recess Width	Min	0.017	0.019	0.019	0.028	0.028	0.030	0.031	0.034	0.036	0.059
Driver Size			1	1	1	2	2	2	2	3	3	4
Recess Penetration Gaging Depth	Max	0.052	0.061	0.071	0.072	0.080	0.097	0.113	0.124	0.144	0.173	
	Min	0.034	0.043	0.053	0.046	0.055	0.071	0.089	0.098	0.118	0.149	

附註：

1. 參考 IFI ANSI/ASME B18.6.3
2. 彈簧華司請參閱 IFI ANSI/ASME B18.13
3. 平華司請參閱 IFI ANSI/ASME B18.22.1
4. 內(外)齒請參閱 IFI ANSI/ASME B18.13